

## **The Camden (Prescribed Routes) (No. 11) Traffic Order 2018**

Notice is hereby given that the Council of the London Borough of Camden proposes to make the above Orders under Sections 6 and 124 and Part IV of Schedule 9 to the Road Traffic Regulation Act 1984, as amended. The general nature and effect of the orders are set out below.

**Midland Road:** designation of one-way working, north to south, between the junctions with Pancras Road and Euston Road (i.e. the entire length of the road). Cyclists travelling in the northbound cycle track on the west side of the road (see below) will be exempt.

Copies of the proposed order and the Council's Statement of Reasons for proposing to make the orders may be inspected / obtained by contacting [traffic.orders@camden.gov.uk](mailto:traffic.orders@camden.gov.uk) or at the council's offices at 5 Pancras Square, N1C 4AG. Any person wishing to object or make representations in respect of the proposed orders, should send comments in writing, giving reasons for any objection to [traffic.orders@camden.gov.uk](mailto:traffic.orders@camden.gov.uk) or by post to the Director of Regeneration & Planning, Supporting Communities Directorate, Camden Town Hall, Judd Street, London WC1H 9JE, to be received by the end of **29 November** 2018.

Notice is also given under s.65 of the Highways Act 1980 of the council's intention to construct cycle tracks in Midland Road on both sides of the carriageway. The cycle track on the east side will accommodate cyclists travelling southbound, the cycle track on the west side will accommodate cyclists travelling northwards.

Peter Mardell  
Head of Parking Operations  
8 November 2018

## **The Camden (Prescribed Routes) (No. 11) Traffic Order 2018**

### STATEMENT OF REASONS

The whole of Midland Road is to be designated as one-way working southbound on a permanent basis in order to facilitate cycle tracks either side of the carriageway. The cycle tracks will provide a safe route for cyclists travelling to and from Central London and will link similar tracks in Pancras Road with cycling measures south of Euston Road. The section south of Brill Place has been designated as one-way working for several years and the section north has operated as one-way working for some time due to large-scale construction works in the area.

# **The Camden (Prescribed Routes) (No. 11) Traffic Order 2018**

**2018 No. 66**

**MIDLAND ROAD**

# LONDON BOROUGH OF CAMDEN

## TRAFFIC MANAGEMENT ORDER

### 2018 No. 66

The Camden (Prescribed Routes) (No. 11) Traffic Order 2018

Made on

Coming into force on

---

The Council of the London Borough of Camden, after consulting the Commissioner of Police of the Metropolis, in exercise of the powers conferred by sections 6 and 124 of and part IV of schedule 9 to the Road Traffic Regulation Act 1984 [1984 c. 27], as amended by section 8 of and part I of schedule 5 to the Local Government Act 1985 [1985 c. 51], and of all other powers thereunto enabling, hereby make the following order:

#### **1. Citation and commencement**

1.1 This order shall come into force on \_\_\_\_\_ and may be cited as the Camden (Prescribed Routes) (No. 11) Traffic Order 2018.

#### **2. Interpretation**

2.1 In this order, the term "pedal cycle" has the same meaning as ascribed to it by the Traffic Signs Regulations and General Directions 2016 [S. I. 2016 No. 362];

2.2 Any reference in this order to any enactment shall be construed as a reference to that enactment as amended, applied, consolidated, re-enacted by or as having effect by virtue of any subsequent enactment.

#### **3. Amendment to existing order**

3.1 Without prejudice to the validity of anything done or to any liability incurred in respect of any act or omission before the coming into force of this order, the Camden (Prescribed Route) (No. 2) Traffic Order 2007 [L.B.C. 2007 No. 10] shall have effect as though Article 4 was omitted.

#### **4. Restrictions**

4.1 No person shall cause any vehicle to proceed in Midland Road in any direction other than from north to south.

#### **5. Exemptions**

7.1 Nothing in Article 4 shall apply in respect of;

7.1.1 a pedal cycle proceeding northwards in the cycle track constructed on the western side of the road;

- 7.1.2 anything done with the permission of a police constable or traffic warden in uniform;
- 7.1.3 any person causing any vehicle to proceed in accordance with any restriction or requirement indicated by traffic signs placed pursuant to Section 66 or 67 of the Road Traffic Regulation Act 1984.

**Dated this**

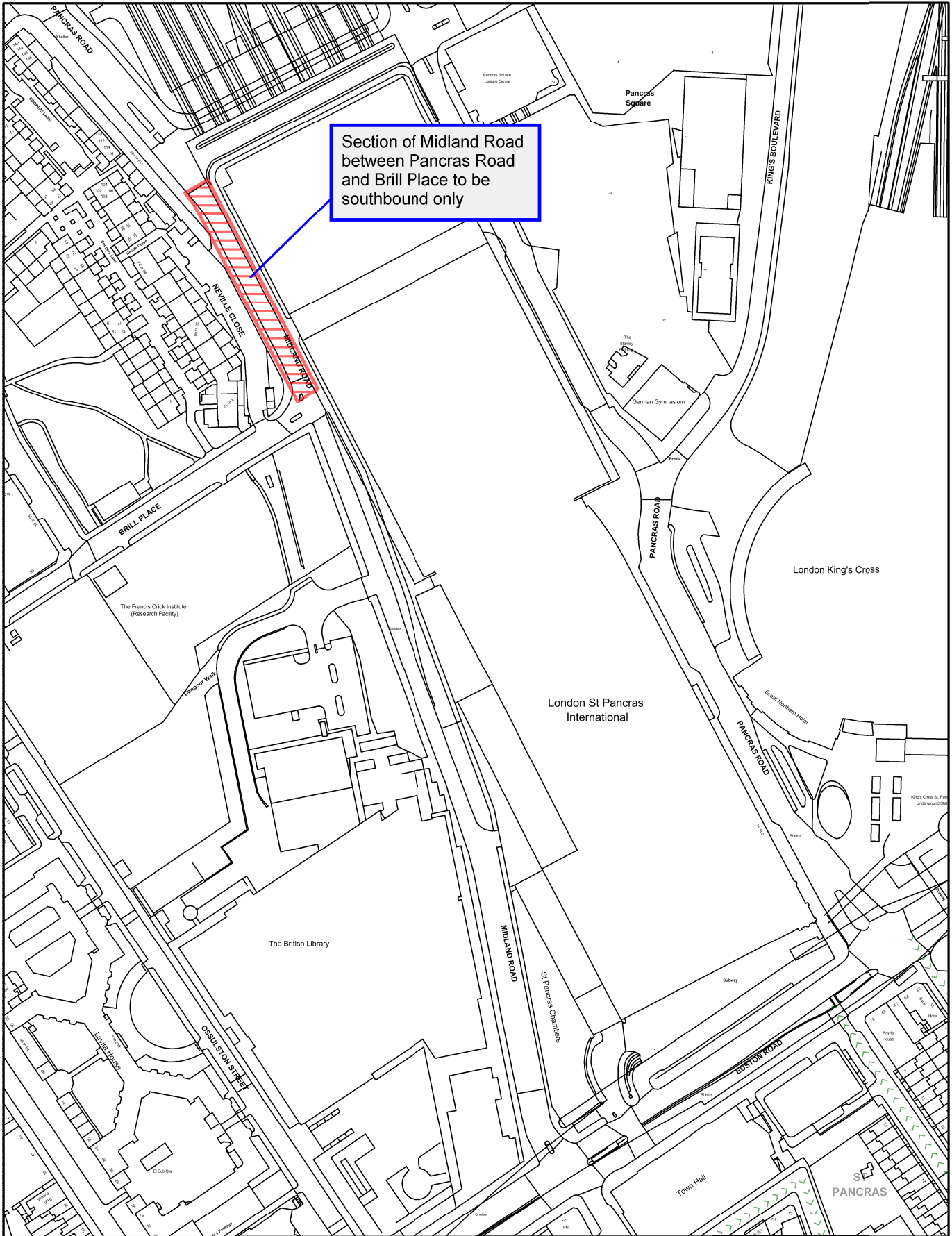

Section of Midland Road  
between Pancras Road  
and Brill Place to be  
southbound only

# Midland Road



© Crown copyright and database rights 2018 OS 100019726

Scale 1: 1250

Print Date: 07/11/2018



Printed By: PM

Map Ref No: